

# LARGE BARRIER



## PRODUCT DESCRIPTION

The new Barrier brings lightweight portability to advertising barrier display systems! Suitable for indoor use, use the Barrier as crowd control at your next trade show or event. Custom printed dye-sub fabric graphic drapes over entire aluminum frame and zips closed. Choose single-sided graphic with black or white backside or double-sided graphic.

DISPLAY DIMENSION	78" W x 35" H
-------------------	---------------

GRAPHIC DIMENSIONS	81" W x 36" H
--------------------	---------------

## GRAPHIC MATERIAL

Stretch Fabric

## GRAPHIC FINISHING

Sewn left, right, and top with a zipper at the bottom

## DISPLAY CONSTRUCTION

Aluminum Frame

## SHIPPING WEIGHTS & DIMENSIONS

Shipping Weight	20 lbs (frame only) 21 lbs (with graphics)
-----------------	---

Shipping Dimensions	28" H x 12.5" W x 6" D
---------------------	------------------------

## LARGE QUANTITY FREIGHT

Freight Shipping	40 boxes per 48" L x 40" W x 66" H skids
------------------	--

Freight Weight	800 lbs (frame only) 840 lbs (with graphics)
----------------	---

# LARGE BARRIER

## PARTS LIST



Qty 2 - Curved Tube



Qty 2 - Vertical Tube



Qty 2 - L Tube



Qty 4 - Horizontal Tube



Qty 2 - Middle Tube



Qty 2 - Wire Lock Pin



Qty 2 - Feet

# LARGE BARRIER

## SET UP INSTRUCTIONS

### Set Up Frame

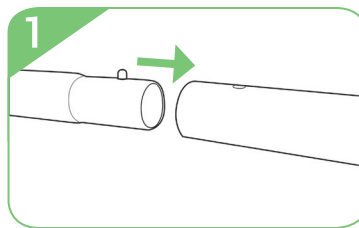
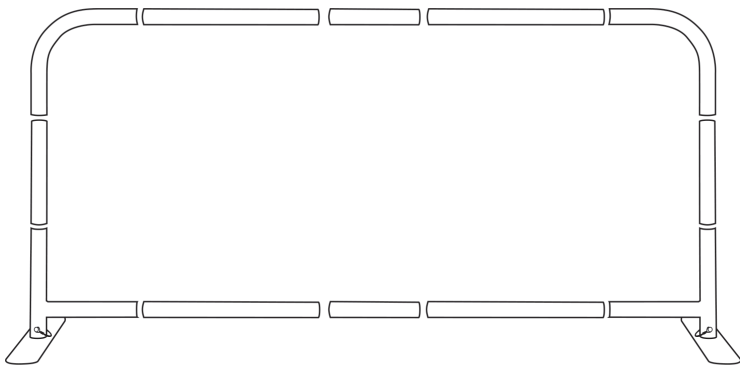

Connect numbered tubes together.

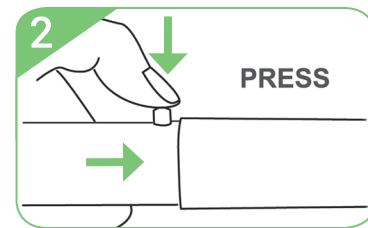

Push down on button and insert tube.

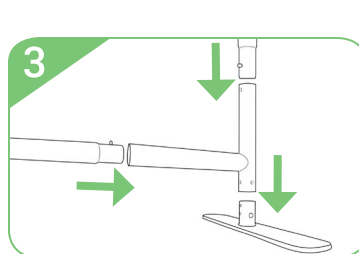

Attach corner tube onto feet. Then connect vertical and horizontal tubes to complete frame.

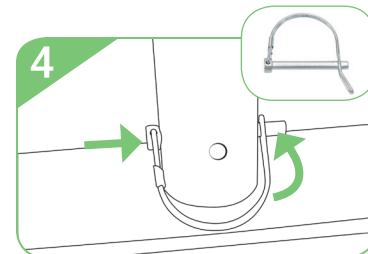

Insert wire lock pin onto the side of feet. Then pull wire loop over end of the pin to secure feet.

### Install Graphic

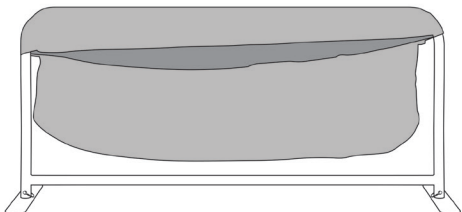

a. Drape graphic over frame.



b. Pull down graphic to cover whole frame.



c. Zip underneath the bottom support pole.